

DESCRIPTION:

Recessed LED inground uplight
 Body made of die cast aluminium with epoxy powder coated surface finish.
 Solid stainless steel frame (316 grade).
 Tempered clear glass diffuser
 Polymer recessed sleeve for easy installation and maintenance.
 Stainless steel cable gland and silicon rubber gasket for water and dust proof.
 Stainless steel screws.
 - Ideal for facade, landscape lighting
 - Heat resistant and solid conduct wiring
 - European standard of EN 60598

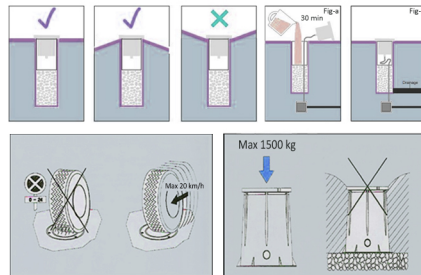
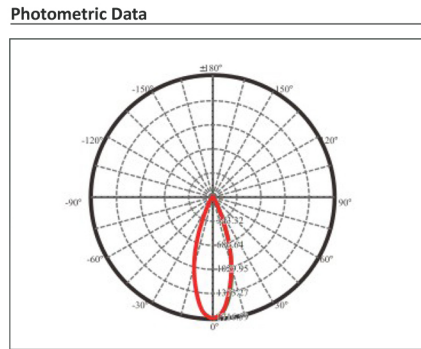

Strictly follow installation instruction
 A gravel bed should be prepared at the time of installation.
 The electric gear is inside the luminaire.

Model	BR-UPL0902A/B/C		
Power	7W LED	9W LED	12W LED
Input Voltage	DC12V / 24V	DC12V / 24V	DC12V / 24V
CRI	≥80	≥80	≥80
Luminous Flux	100LM/W	100LM/W	100LM/W
Color Temp.	2700-6500K/RGB	2700-6500K/RGB	2700-6500K/RGB
Power Factor	>0.95	>0.95	>0.95
Temp. in Working	-20°C +50°C	-20°C +50°C	-20°C +50°C
Efficiency	>90%	>90%	>90%
Beam Angle	10/15/25/38/60°		
Drive	HF Electronic		
	DALI Dimmable (Order Code: "DALI")		
Life Span	50000Hrs		

Built in drive version available on request

